

# Hyatt Regency Chicago

## ROOM DIMENSIONS & CAPACITIES

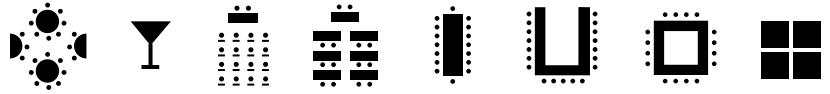

Room name

Room name	Room Dimensions Length x Width x Height	Square Feet	Banquet	Reception	Theater	Classroom	Boardroom	U-Shape	Hollow Square	Exhibit
-----------	--	----------------	---------	-----------	---------	-----------	-----------	---------	---------------	---------

### SILVER LEVEL, WEST TOWER

THIRD FLOOR MEETING ROOMS / FOUNDERS SUITES										
DUSABLE	26' x 28' x 9'	728	48	60	55	36	36	30	35	—
FIELD	27' x 27' x 9'	729	48	60	55	36	34	30	35	—
McCORMICK	27' x 27' x 9'	729	48	60	55	36	34	30	35	—
BURNHAM	27' x 27' x 9'	729	48	60	55	36	34	30	35	—
SANDBURG	16' x 22' x 9'	352	12	10	—	—	8	—	—	—
ADDAMS	28' x 23' x 9'	644	48	60	40	27	24	25	25	—
WRIGHT	28' x 23' x 9'	644	48	60	40	27	24	25	25	—
OGDEN	28' x 23' x 9'	644	48	60	40	27	24	25	25	—
HORNER	28' x 23' x 9'	644	48	60	40	27	24	25	25	—

NOTE: All of the above set ups are maximum capacity seating levels without any additional equipment added.

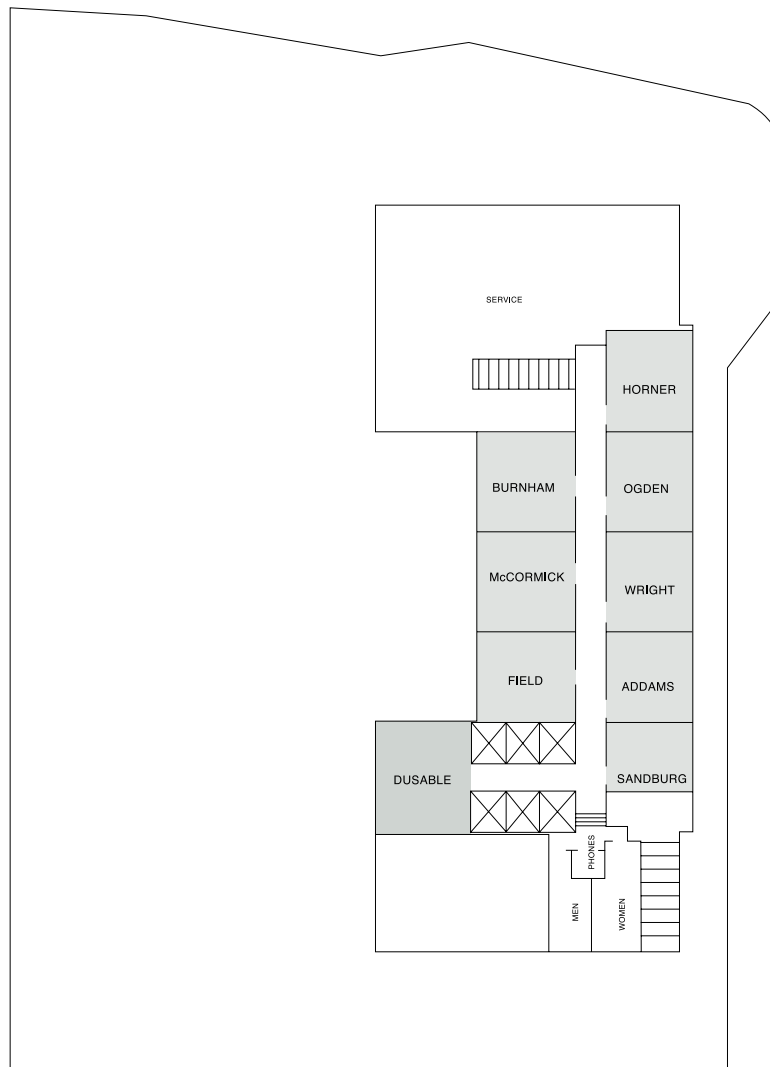

WEST TOWER

# Hyatt Regency Chicago

## ROOM DIMENSIONS & CAPACITIES

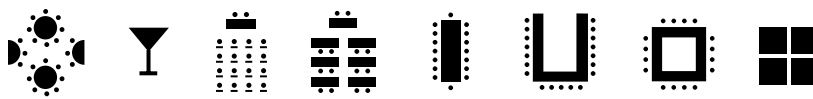

Room name

Room name	Room Dimensions Length x Width x Height	Square Feet	Banquet	Reception	Theater	Classroom	Boardroom	U-Shape	Hollow Square	Exhibit
<b>BLUE LEVEL, EAST TOWER</b>										
<b>SKYWAY CONFERENCE CENTER</b>										
SKYWAY 260	65' x 17' x 9'	1,105	72	100	120	54	30	26	36	—
SKYWAY 261	27' x 18' x 9'	486	12	—	—	—	12	—	—	—
SKYWAY 265	27' x 18' x 9'	486	36	40	35	24	25	24	28	—
SKYWAY 269	27' x 18' x 9'	486	36	40	35	24	25	24	28	—
SKYWAY 272	42' x 17' x 9'	714	48	80	45	42	34	25	30	—
SKYWAY 273	27' x 18' x 9'	486	36	40	35	24	25	24	28	—
SKYWAY 279-285	18' x 13'5" x 9'	243	12	15	15	9	12	10	—	—
<b>BLUE LEVEL, WEST TOWER</b>										
TRUFFLES	55' x 55' x 9'	3,025	120	140	120	63	46	50	60	—

NOTE: All of the above set ups are maximum capacity seating levels without any additional equipment added.

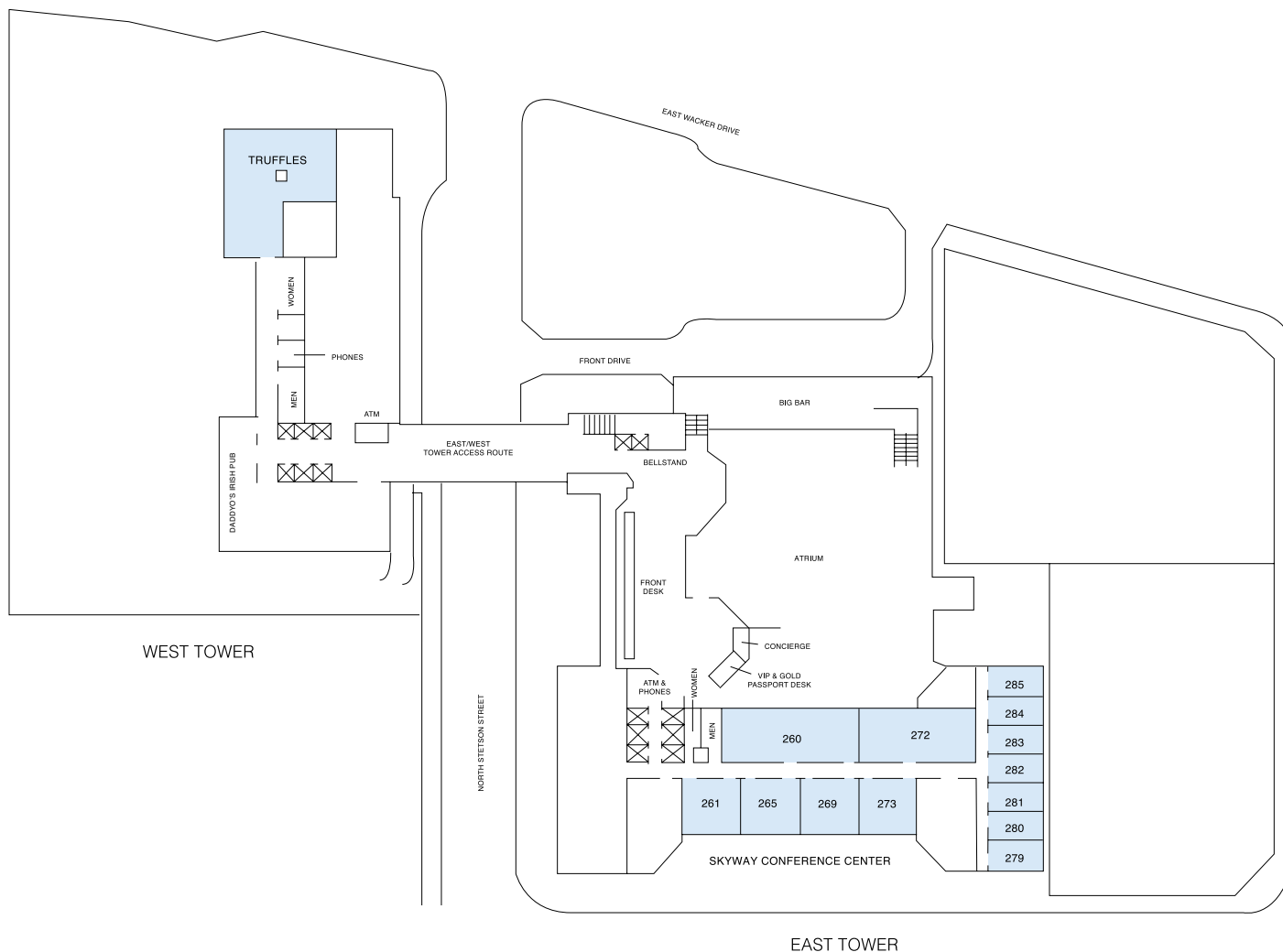

# Hyatt Regency Chicago

## ROOM DIMENSIONS & CAPACITIES

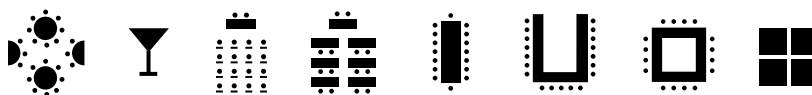

Room name

Room name	Room Dimensions	Square Feet	Configuration							
	Length x Width x Height		Banquet	Reception	Theater	Classroom	Boardroom	U-Shape	Hollow Square	Exhibit
<b>GREEN LEVEL, WEST TOWER</b>										
CRYSTAL BALLROOM	168' x 59' x 19'	9,912	840	1,000	950	525	—	—	—	40
CRYSTAL A	42' x 59' x 19'	2,478	204	250	280	162	50	40	50	—
CRYSTAL B	84' x 59' x 19'	4,956	408	500	532	240	100	93	—	—
CRYSTAL C	42' x 59' x 19'	2,478	204	250	280	162	50	40	50	—
CRYSTAL AB or BC	123' x 61' x 19'	7,503	612	750	869	384	—	—	—	—
CRYSTAL FOYER	—	4,000	—	400	—	—	—	—	—	—
<b>GREEN LEVEL, EAST TOWER</b>										
PLAZA BALLROOM	99' x 29' x 107'	2,871	200	250	225	159	60	67	74	—
PLAZA A	47' x 29' x 107'	1,363	80	130	70	63	24	30	36	—
PLAZA B	52' x 29' x 107'	1,508	120	150	110	96	28	32	38	—

NOTE: All of the above set ups are maximum capacity seating levels without any additional equipment added.

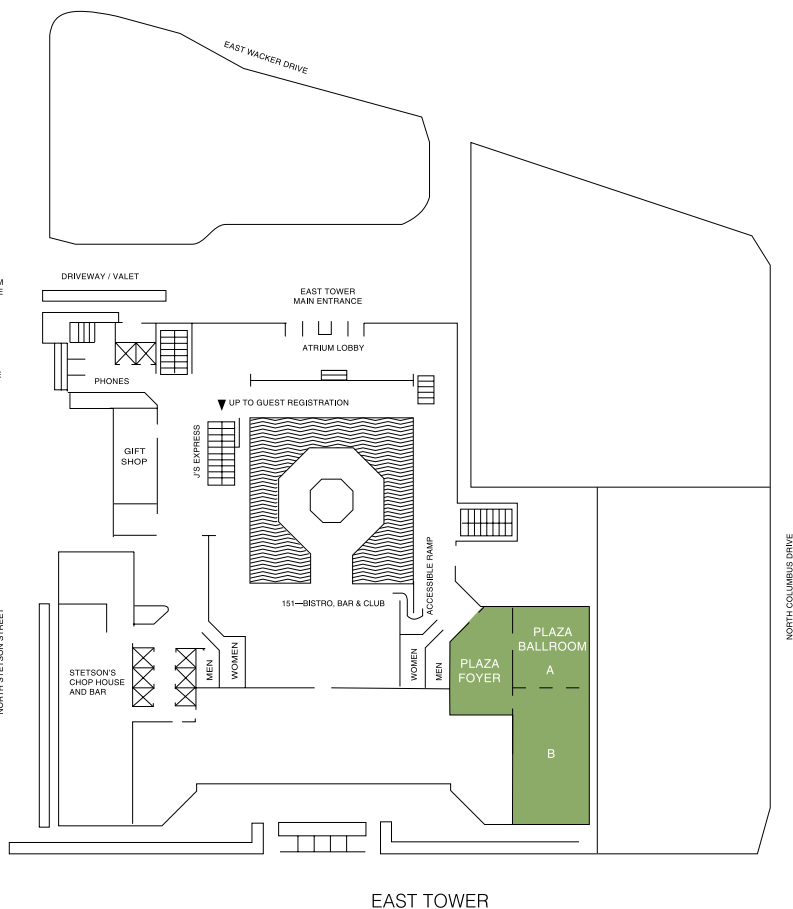
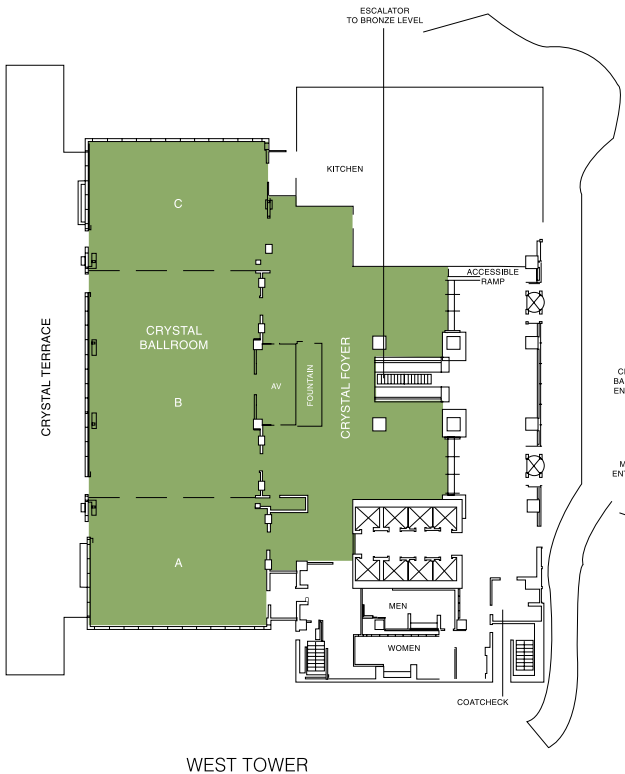

# Hyatt Regency Chicago

## ROOM DIMENSIONS & CAPACITIES

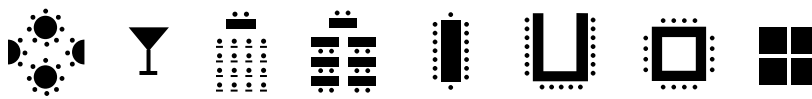

Room name

Room name	Room Dimensions Length x Width x Height	Square Feet	Banquet	Reception	Theater	Classroom	Boardroom	U-Shape	Hollow Square	Exhibit
-----------	--	----------------	---------	-----------	---------	-----------	-----------	---------	---------------	---------

### BRONZE LEVEL, WEST TOWER

LANDMARK SUITES										
COLUMBIAN	28' x 25' x 9'	700	48	60	60	33	26	25	30	—
PICASSO	22' x 30' x 9'	660	48	60	30	30	24	18	24	—
HAYMARKET	21' x 30' x 9'	630	48	60	30	24	24	20	25	—
BUCKINGHAM	26' x 42' x 9'	1,092	60	90	90	39	27	27	33	—
WATER TOWER	25' x 46' x 9'	1,150	80	120	120	54	28	26	36	—
GOLD COAST	25' x 46' x 9'	1,150	80	120	120	54	28	26	36	—
COMISKEY	38' x 55' x 9'	2,090	120	200	120	90	50	55	60	—
WRIGLEY	45' x 52' x 9'	1,615	84	140	60	48	30	25	30	—
SOLDIER FIELD	34' x 25' x 9'	820	48	70	45	30	24	25	30	—

NOTE: All of the above set ups are maximum capacity seating levels without any additional equipment added.

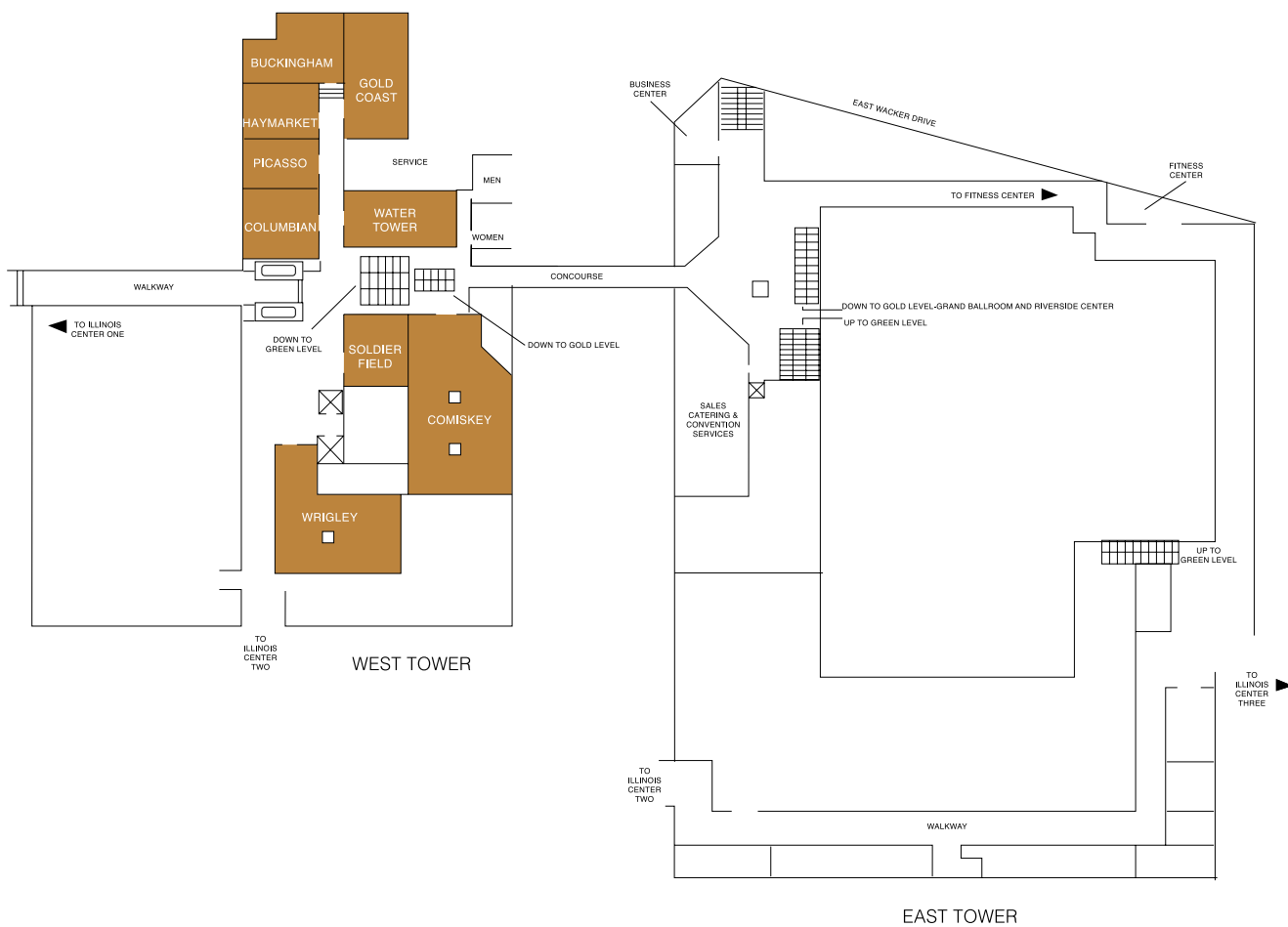

# Hyatt Regency Chicago

## ROOM DIMENSIONS & CAPACITIES

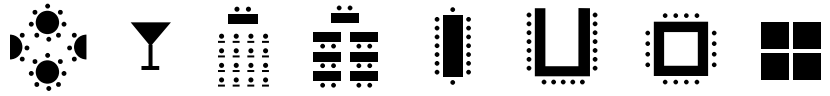

Room name

Room name	Room Dimensions Length x Width x Height	Square Feet	Banquet	Reception	Theater	Classroom	Boardroom	U-Shape	Hollow Square	Exhibit
<b>GOLD LEVEL, EAST TOWER</b>										
GRAND BALLROOM	213' x 114' x 17'	24,282	2,280	3,000	2,650	1,250	—	—	—	137
GRAND A or B	71' x 57' x 17'	4,047	240	400	400	250	74	80	100	20
GRAND AB	71' x 114' x 17'	8,094	480	800	800	500	—	—	—	45
GRAND C or D	71' x 57' x 17'	4,047	240	400	400	250	74	80	100	20
GRAND CD	71' x 114' x 17'	8,094	480	800	800	500	—	—	—	51
GRAND C or D NORTH	36' x 57' x 17'	2,052	120	200	200	110	36	40	50	—
GRAND C or D SOUTH	36' x 57' x 17'	2,052	120	200	200	110	36	40	50	—
GRAND CD NORTH or SOUTH	71' x 57' x 17'	4,047	240	400	400	250	74	80	100	25
GRAND E or F	71' x 57' x 17'	4,047	240	400	400	250	74	80	100	20
GRAND EF	71' x 114' x 17'	8,094	480	800	800	500	—	—	—	45
COLUMBUS HALL	117' x 184' x 10'	21,528	1,500	1,800	—	—	—	—	—	93
COLUMBUS AB	59' x 36' x 10'	2,124	120	200	180	120	50	55	60	12
COLUMBUS CD	59' x 36' x 10'	2,124	120	200	180	120	50	55	60	12
COLUMBUS EF	59' x 38' x 10'	2,242	144	225	200	159	54	60	65	12
COLUMBUS G or H	38' x 35' x 10'	1,330	60	115	80	48	36	36	40	—
COLUMBUS GH	76' x 36' x 10'	2,736	180	250	225	159	60	70	80	12
COLUMBUS IJ	76' x 36' x 10'	2,736	180	250	225	159	60	70	80	12
COLUMBUS KL	76' x 38' x 10'	2,888	180	250	225	159	60	70	80	12
<b>GRAND SUITES</b>										
GRAND SUITE 1	14' x 19' x 9'	264	24	25	25	15	8	10	8	—
GRAND SUITE 2A	20' x 26' x 9'	520	24	35	30	24	10	6	12	—
GRAND SUITE 2B	16' x 14' x 9'	224	12	15	15	9	8	—	—	—
GRAND SUITE 2AB	42' x 14' x 9'	588	60	75	60	30	14	12	18	—
GRAND SUITE 3	25' x 57' x 9'	1,425	72	130	120	69	40	32	36	—
GRAND SUITE 4	14' x 23' x 9'	322	—	—	—	—	8	—	—	—
GRAND SUITE 5	23' x 49' x 9'	1,127	60	100	96	60	30	22	25	—
<b>GOLD LEVEL, WEST TOWER</b>										
REGENCY BALLROOM	72' x 230' x 11'8"	16,100	1,200	1,600	1,600	756	—	—	—	90
REGENCY A, B, C, or D	72' x 58' x 11'8"	4,061	300	400	400	230	70	72	100	20
REGENCY AB, BC, or CD	72' x 117' x 11'8"	8,194	600	800	800	405	—	—	—	40
REGENCY ABC or BCD	72' x 174' x 11'8"	12,183	900	1,200	1,200	567	—	—	—	60
INTERNATIONAL SUITES	60' x 81' x 7'6"	4,860	288	350	—	—	—	—	—	22
TORONTO	60' x 27' x 7'6"	1,620	120	150	120	96	55	55	60	10
HONG KONG	28' x 27' x 7'6"	756	48	50	80	36	30	30	40	3
ACAPULCO	60' x 27' x 7'6"	1,620	120	150	120	96	55	55	60	10
<b>CITY SUITES</b>										
ATLANTA	24' x 32' x 7'	768	48	60	66	36	24	18	24	—
SAN FRANCISCO	25' x 26' x 7'	650	48	60	40	27	24	29	32	—
NEW ORLEANS	26' x 34' x 7'	884	60	70	60	45	30	24	30	—
<b>WEST TOWER (36TH FLOOR)</b>										
BOARD OF TRADE	23' x 27'	621	—	—	—	—	18	—	—	—

NOTE: All of the above set ups are maximum capacity seating levels without any additional equipment added.

# Hyatt Regency Chicago

## ROOM DIMENSIONS & CAPACITIES

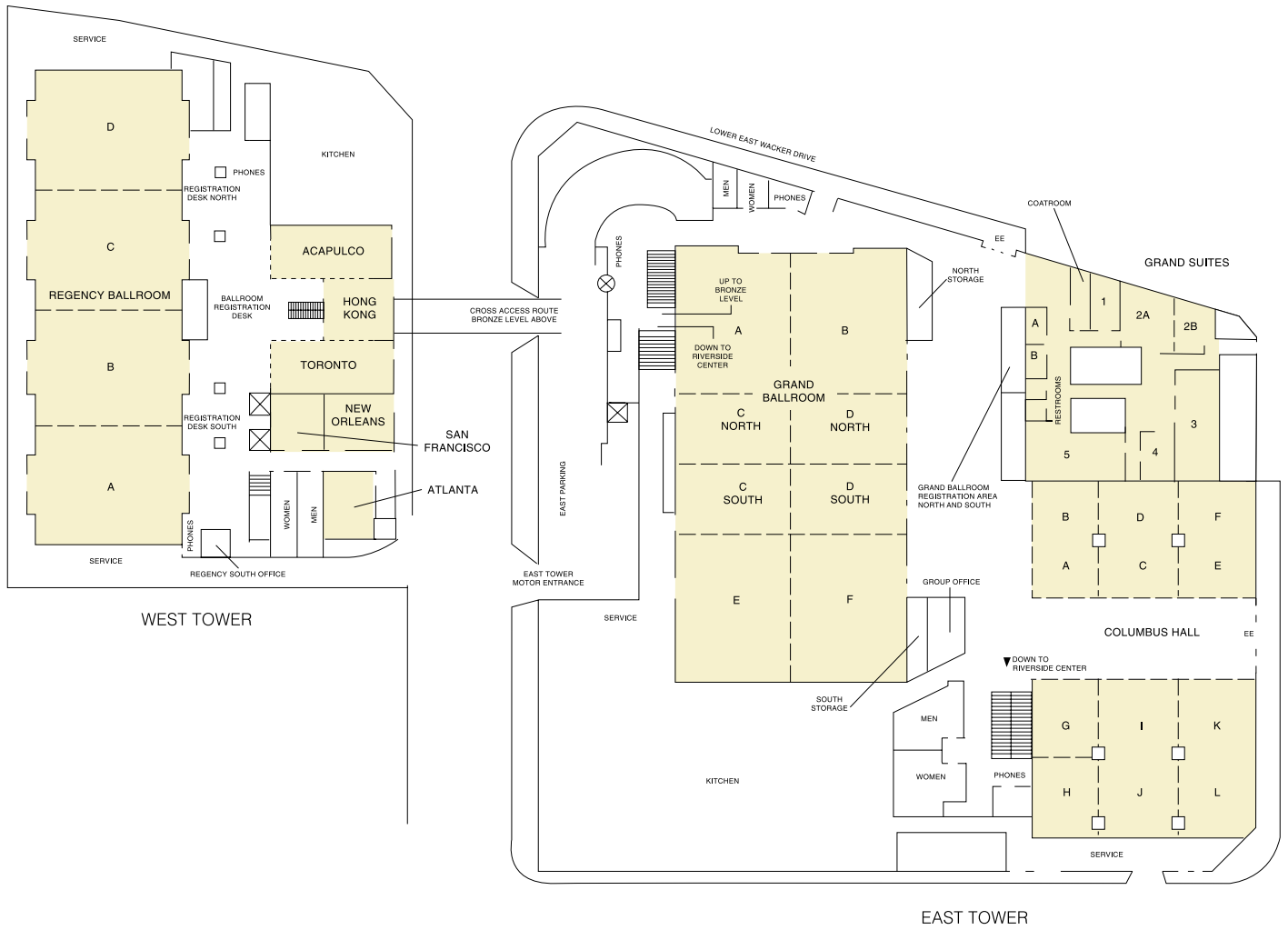

# Hyatt Regency Chicago

## ROOM DIMENSIONS & CAPACITIES

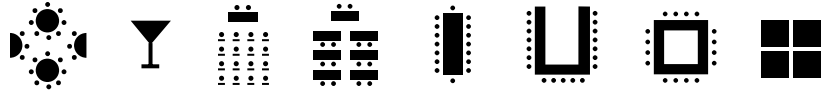

Room name

Room name	Room Dimensions Length x Width x Height	Square Feet	Banquet	Reception	Theater	Classroom	Boardroom	U-Shape	Hollow Square	Exhibit
-----------	--	----------------	---------	-----------	---------	-----------	-----------	---------	---------------	---------

### PURPLE LEVEL, EAST TOWER

RIVERSIDE CENTER EXHIBITION HALL										
HALL	CEILING HEIGHT 12'	70,000	2,676	7,000	—	—	—	—	—	355
EAST	—	30,000	1,044	2,500	—	—	—	—	—	151
WEST	—	40,000	1,596	4,500	3,315	—	—	—	—	204
EAST DOCK (D, E, F)	—	3 Bays	—	—	—	—	—	—	—	—

### PURPLE LEVEL, WEST TOWER

STETSON CONFERENCE CENTER										
STETSON SUITE A	9' x 19' x 8'	378	12	25	30	18	12	14	18	—
STETSON SUITE BC	30' x 17' x 8'	510	36	40	45	18	24	27	30	—
STETSON SUITE D	18' x 24' x 8'	432	12	25	30	18	20	10	12	—
STETSON SUITE E	30' x 27' x 8'	810	48	55	50	21	26	14	16	—
STETSON SUITE F	36' x 25' x 8'	900	60	60	70	45	45	18	20	—
STETSON SUITE G	36' x 14' x 8'	504	36	40	48	27	14	14	14	—
STETSON SUITE F-G	36' x 39' x 8'	1,404	96	90	100	—	22	16	22	—

NOTE: All of the above set ups are maximum capacity seating levels without any additional equipment added.



# Hyatt Regency Chicago

## DIRECTIONS

From O'Hare International Airport (18 miles): Take Kennedy Expressway (I-90 / 94) East to Ohio St. exit. Proceed on Ohio to Michigan Ave. and turn right. Turn left on Lake St., then turn left on Stetson St.

From Midway Airport (12 miles): Take Cicero Ave. North to Stevenson Expressway (I-55) Northbound to Lake Shore Drive North. Exit at Randolph / Wacker Drive, follow Wacker Drive signs, proceed up the ramp and Hyatt will be on the left.

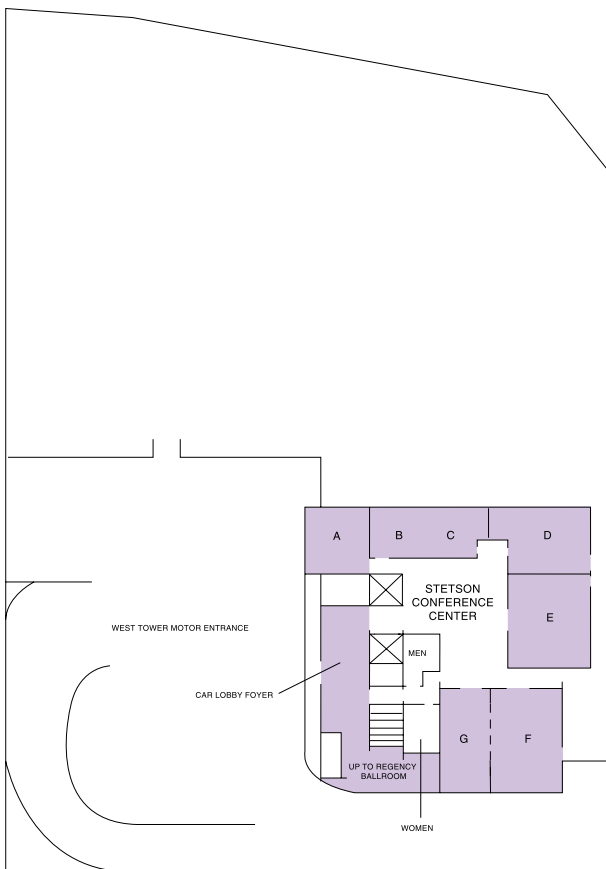

WEST TOWER

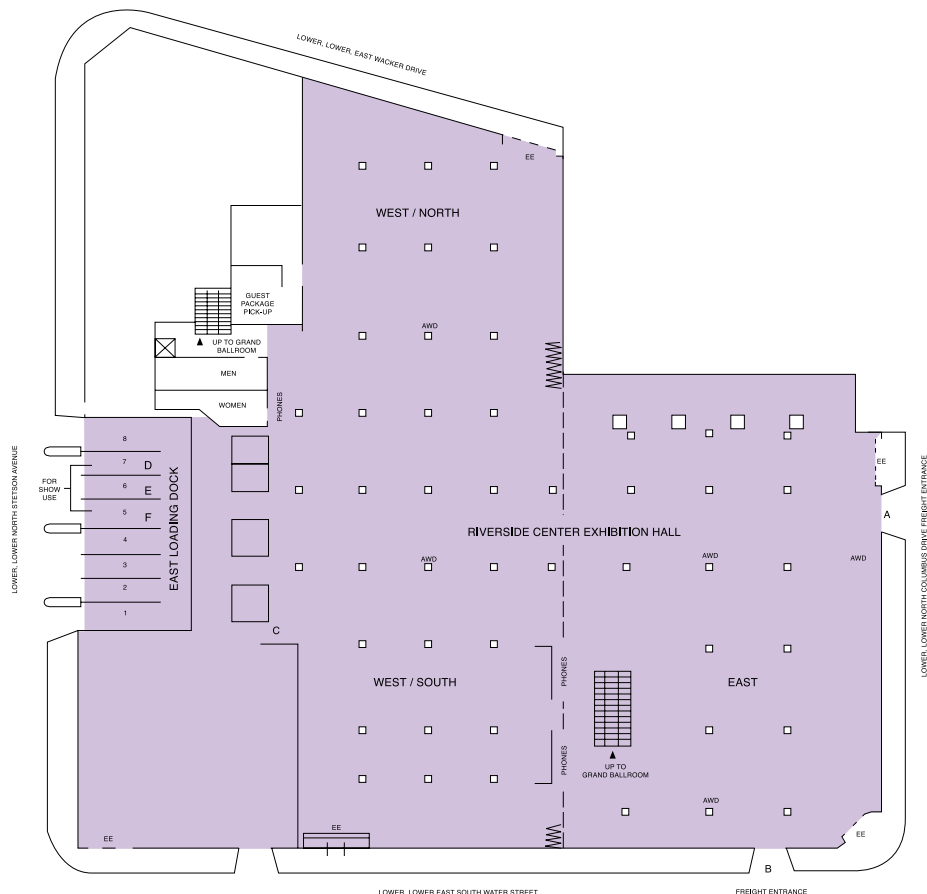

EAST TOWER